

FLOOR PLAN

FINISH KEY PLAN

- FL1
- FL2
- FL3
- FL4
- FL5
- FL6



ORIGINAL FLOOR PLAN

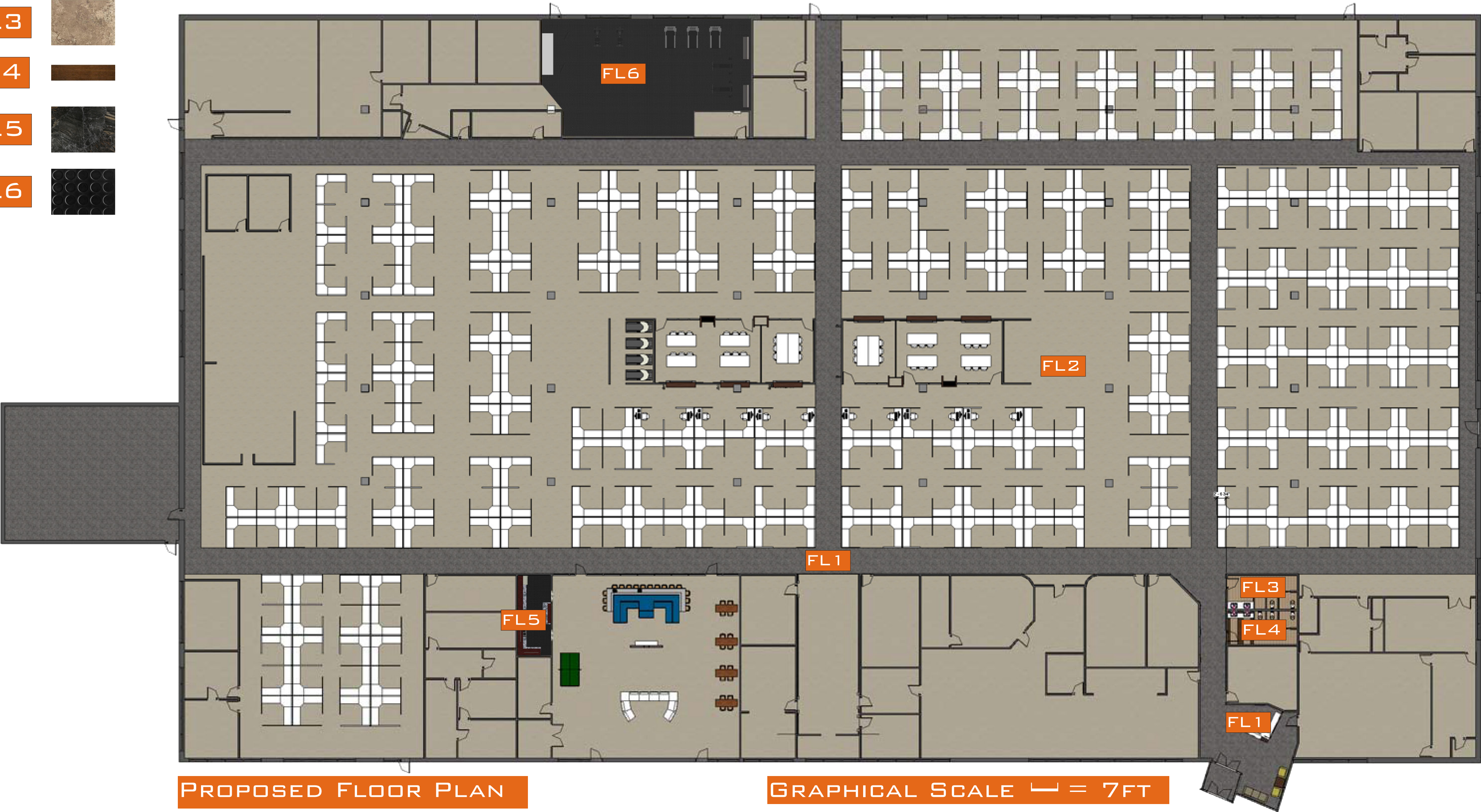

PROPOSED FLOOR PLAN

GRAPHICAL SCALE — = 7FT

MOLLIE SMITH.  
CHANTELLE BALSER.  
ZECH SMITH.  
MARY JOHANTGES.

DESIGN  
STATEMENT

THROUGH THE USE OF INNOVATIVE ARCHITECTURAL ELEMENTS, SPACE PLANNING, AND MATERIAL AND COLOR USAGE, WE MET THE NEEDS AND DESIRES OF OUR CLIENTS, WHICH WAS THE PRIMARY OBJECTIVE IN APPROACHING THIS PROJECT. THE DESIGNS ARE CLEAN, FRESH, AND SIMPLISTIC, ALL CONTRIBUTING TO AN ENGAGING AND INSPIRING ATMOSPHERE THAT WILL STIMULATE A PRODUCTIVE WORK ENVIRONMENT.



# ONTARIO SYSTEMS

## REFLECTED CEILING PLAN

### LIGHTING KEY PLAN

L1

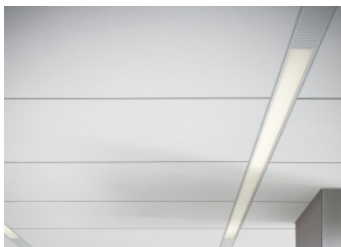

L2



L3

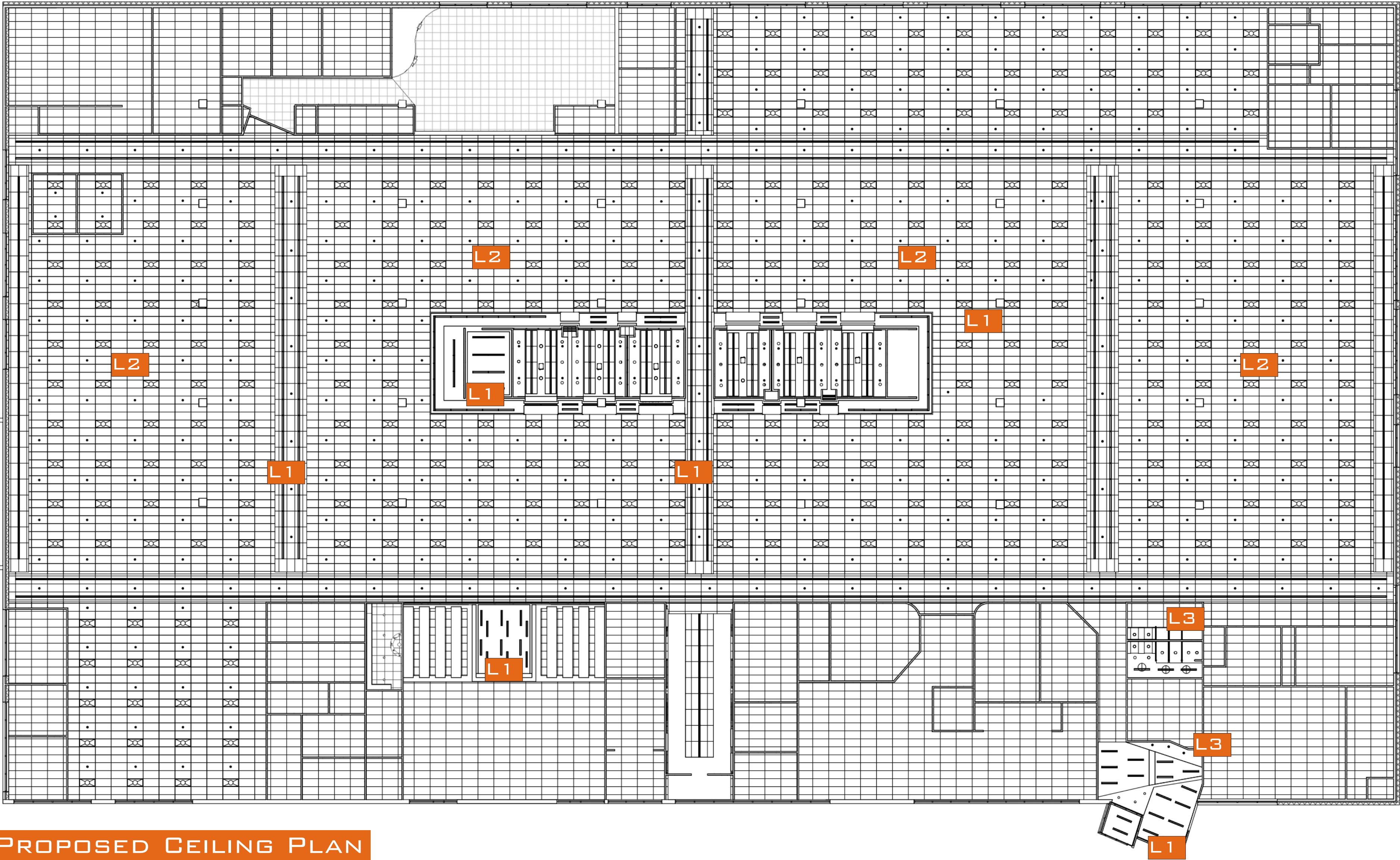

PROPOSED CEILING PLAN

MOLLIE SMITH.  
CHANTELLE BALSER.  
ZECH SMITH.  
MARY JOHANTGES.

### DESIGN STATEMENT

THROUGH THE USE OF INNOVATIVE ARCHITECTURAL ELEMENTS, SPACE PLANNING, AND MATERIAL AND COLOR USAGE, WE MET THE NEEDS AND DESIRES OF OUR CLIENTS, WHICH WAS THE PRIMARY OBJECTIVE IN APPROACHING THIS PROJECT. THE DESIGNS ARE CLEAN, FRESH, AND SIMPLISTIC, ALL CONTRIBUTING TO AN ENGAGING AND INSPIRING ATMOSPHERE THAT WILL STIMULATE A PRODUCTIVE WORK ENVIRONMENT.



# ONTARIO SYSTEMS

## FRONT ENTRY

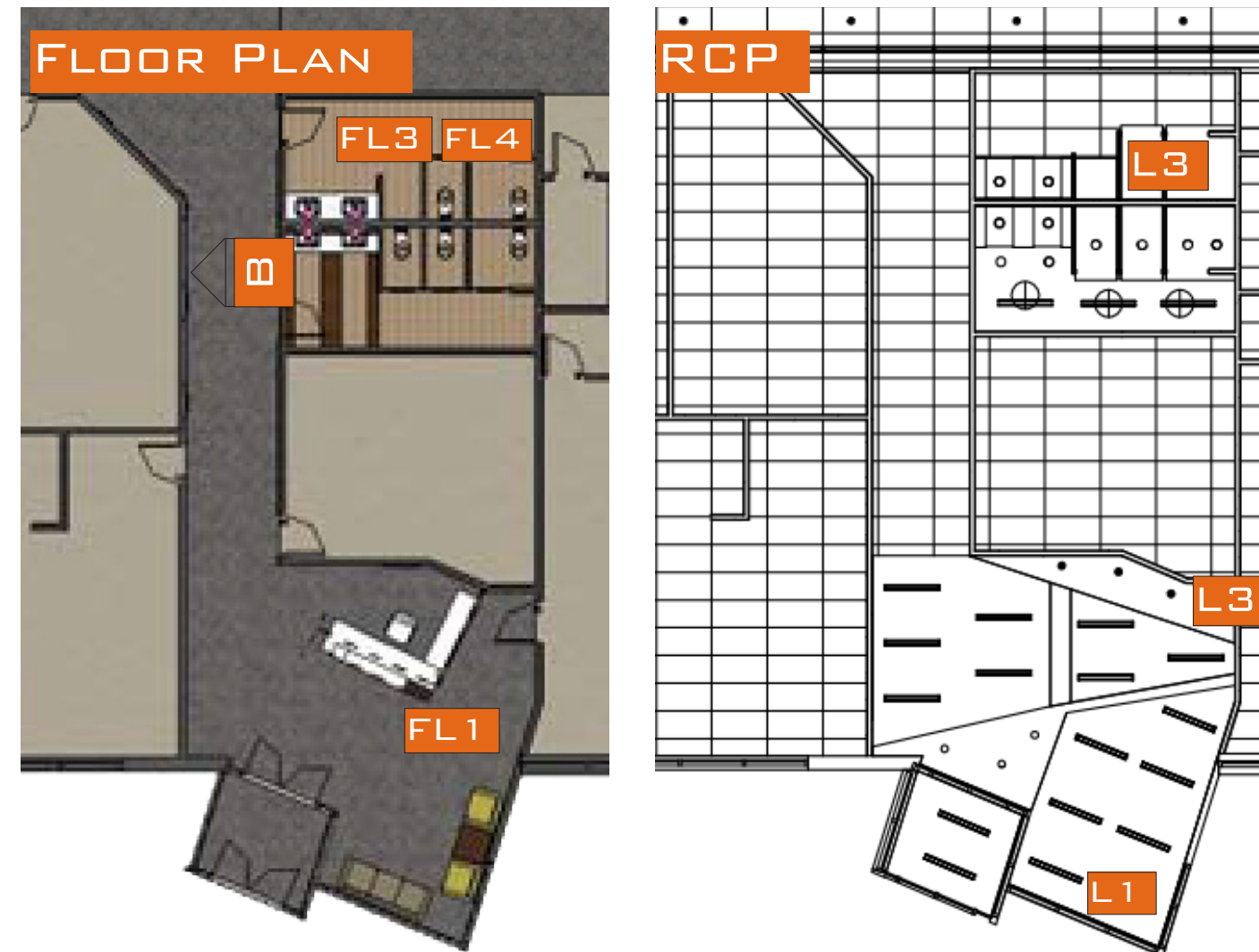

ENTRY



HISTORY WALL



ELEVATION B



BEFORE



BATHROOM



BEFORE



BEFORE

MOLLIE SMITH.  
CHANTELLE BALSER.  
ZECH SMITH.  
MARY JOHANTGES.

### DESIGN STATEMENT

THROUGH THE USE OF INNOVATIVE ARCHITECTURAL ELEMENTS, SPACE PLANNING, AND MATERIAL AND COLOR USAGE, WE MET THE NEEDS AND DESIRES OF OUR CLIENTS, WHICH WAS THE PRIMARY OBJECTIVE IN APPROACHING THIS PROJECT. THE DESIGNS ARE CLEAN, FRESH, AND SIMPLISTIC, ALL CONTRIBUTING TO AN ENGAGING AND INSPIRING ATMOSPHERE THAT WILL STIMULATE A PRODUCTIVE WORK ENVIRONMENT.



# ONTARIO SYSTEMS

## MAIN OFFICE

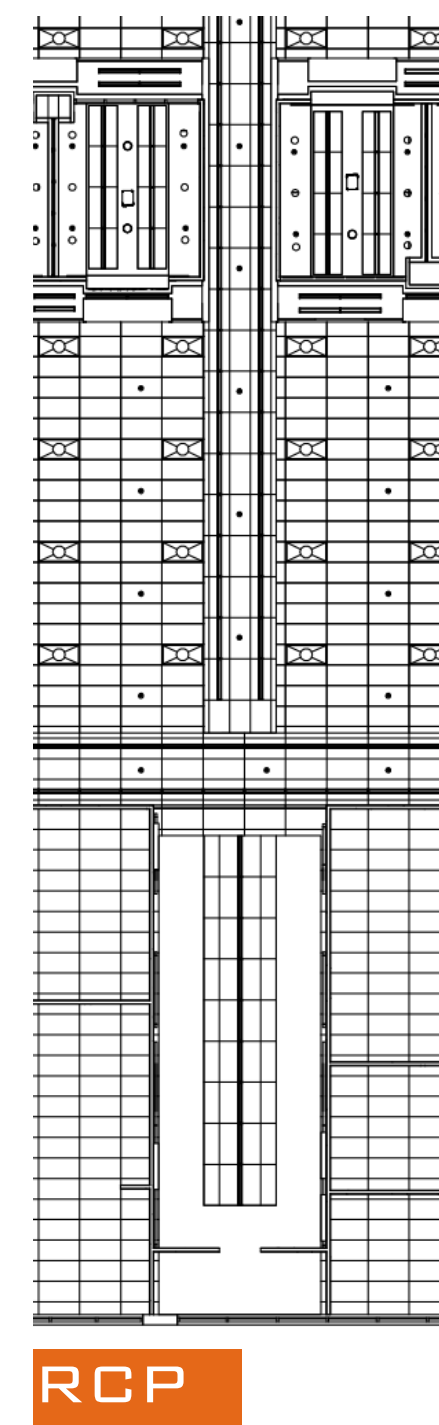
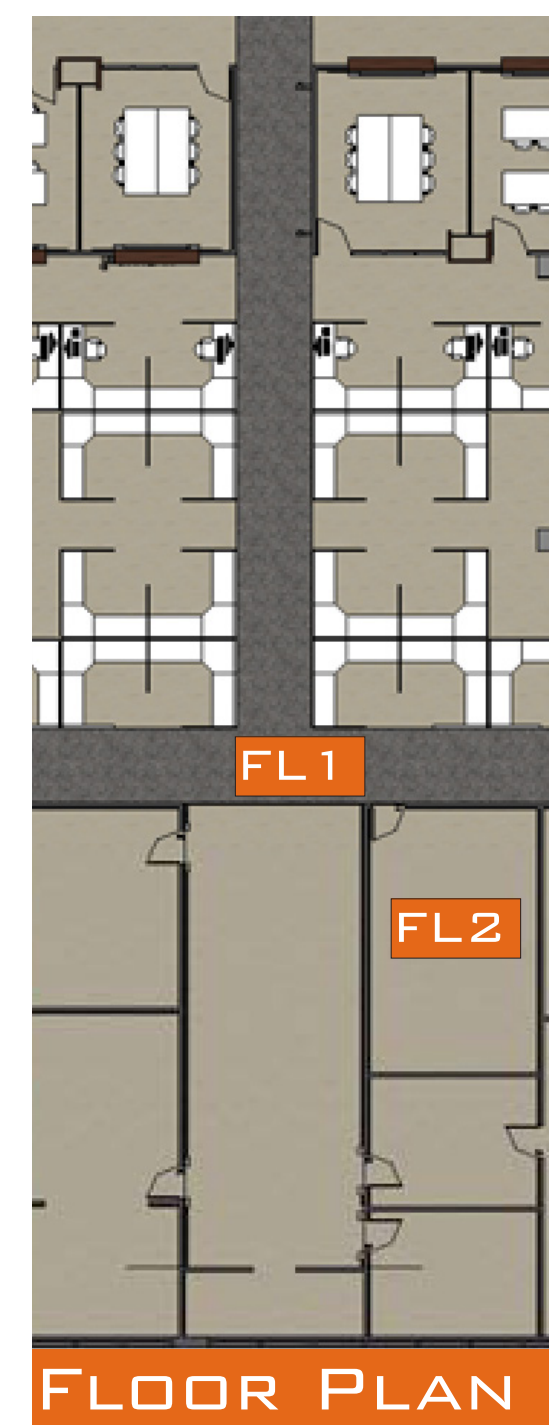

MOLLIE SMITH.  
CHANTELLE BALSER.  
ZECH SMITH.  
MARY JOHANTGES.

### DESIGN STATEMENT

THROUGH THE USE OF INNOVATIVE ARCHITECTURAL ELEMENTS, SPACE PLANNING, AND MATERIAL AND COLOR USAGE, WE MET THE NEEDS AND DESIRES OF OUR CLIENTS, WHICH WAS THE PRIMARY OBJECTIVE IN APPROACHING THIS PROJECT. THE DESIGNS ARE CLEAN, FRESH, AND SIMPLISTIC, ALL CONTRIBUTING TO AN ENGAGING AND INSPIRING ATMOSPHERE THAT WILL STIMULATE A PRODUCTIVE WORK ENVIRONMENT.



# ONTARIO SYSTEMS

## CONFERENCE ROOMS

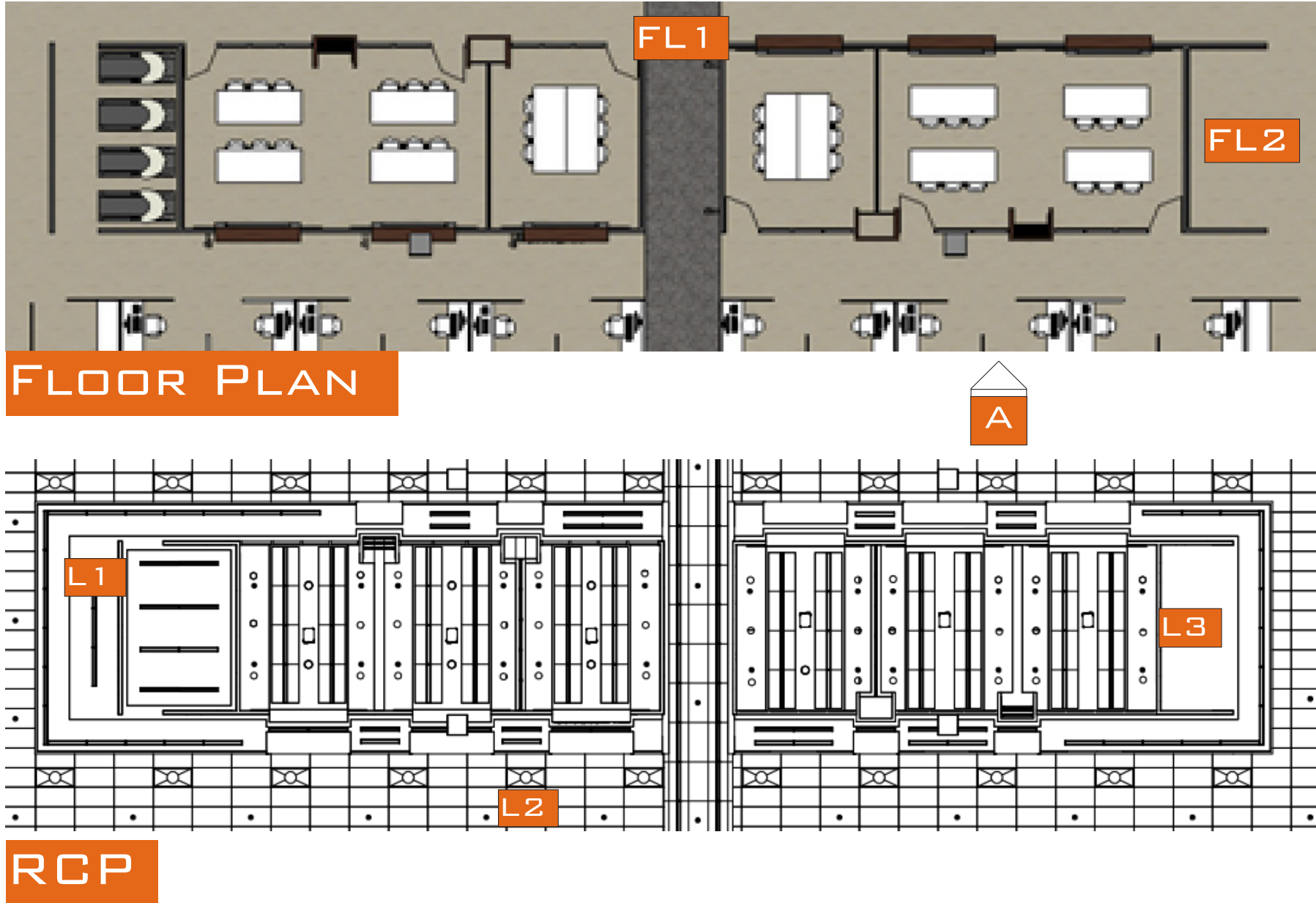

MOLLIE SMITH.  
CHANTELLE BALSER.  
ZECH SMITH.  
MARY JOHANTGES.

### DESIGN STATEMENT

THROUGH THE USE  
OF INNOVATIVE  
ARCHITECTURAL  
ELEMENTS, SPACE  
PLANNING, AND  
MATERIAL AND  
COLOR USAGE, WE  
MET THE NEEDS  
AND DESIRES OF  
OUR CLIENTS,  
WHICH WAS THE  
PRIMARY OBJECTIVE  
IN APPROACHING  
THIS PROJECT.  
THE DESIGNS ARE  
CLEAN, FRESH,  
AND SIMPLISTIC,  
ALL CONTRIBUTING  
TO AN ENGAGING  
AND INSPIRING  
ATMOSPHERE THAT  
WILL STIMULATE A  
PRODUCTIVE WORK  
ENVIRONMENT.



# ONTARIO SYSTEMS

## BREAK ROOM

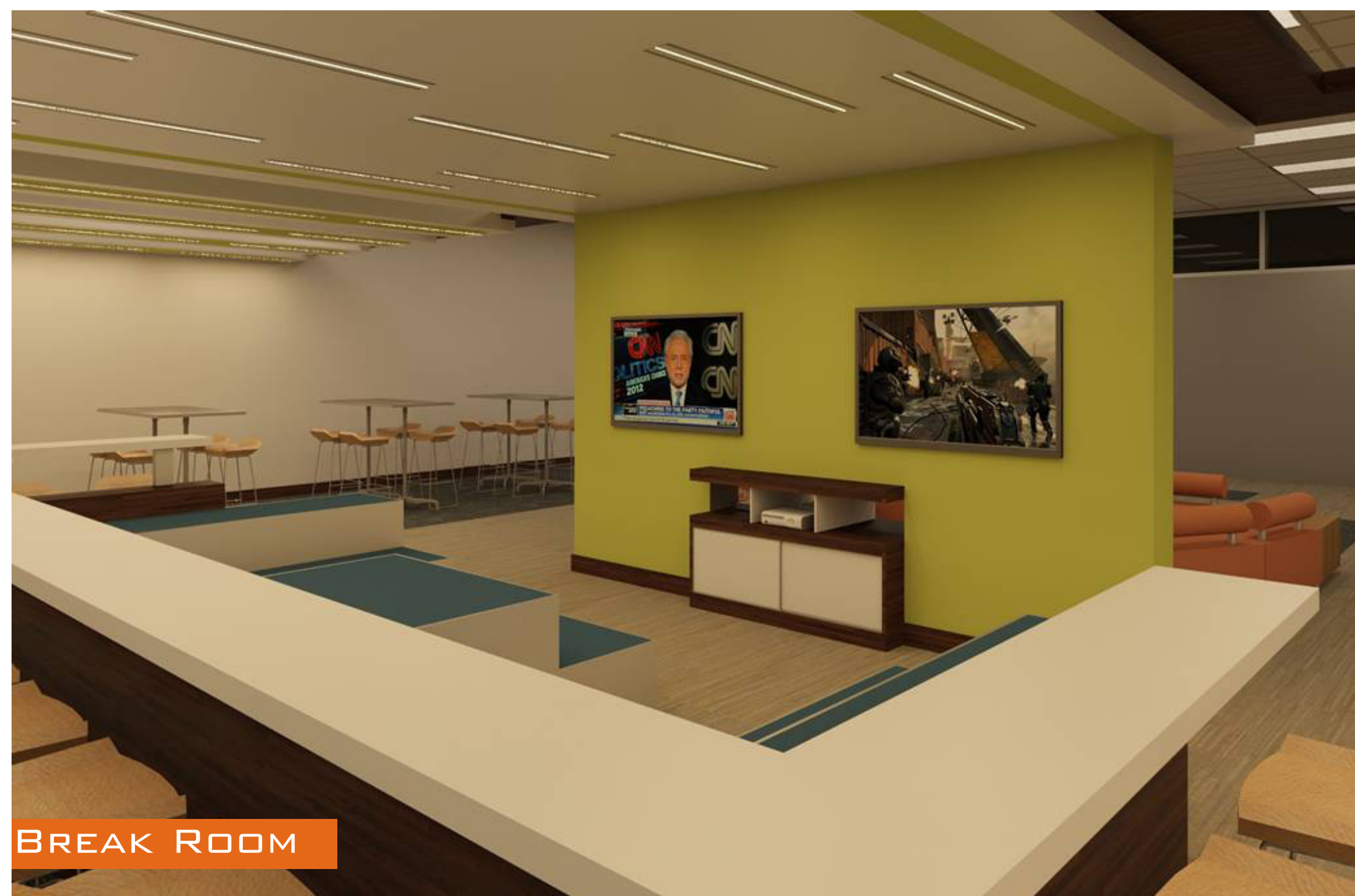
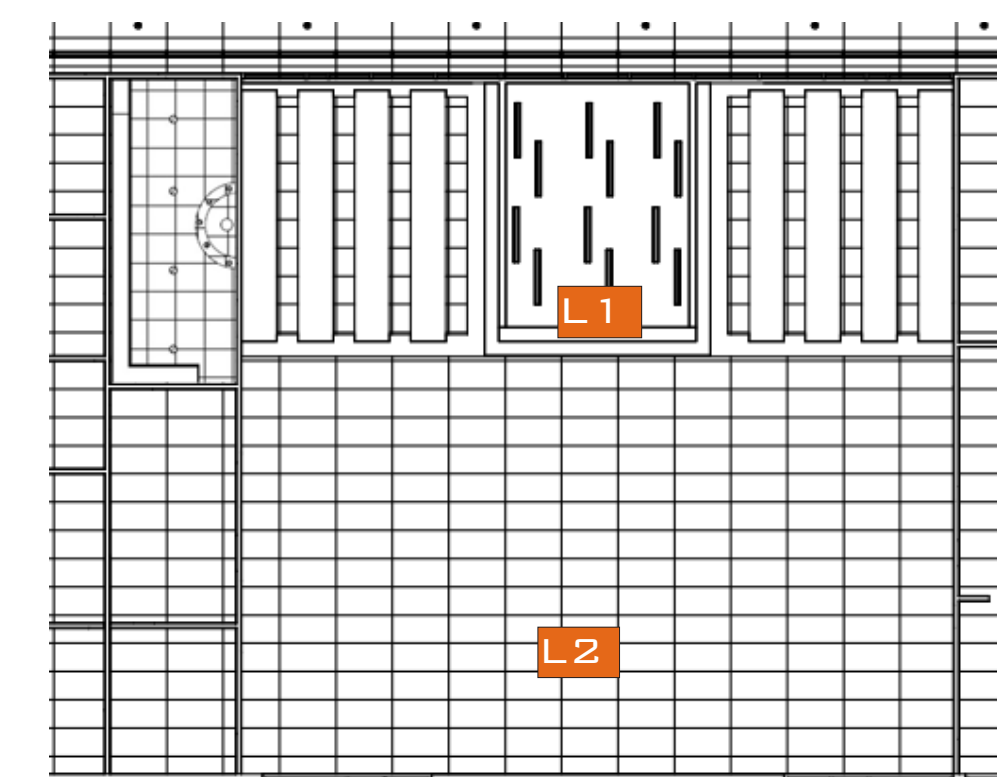
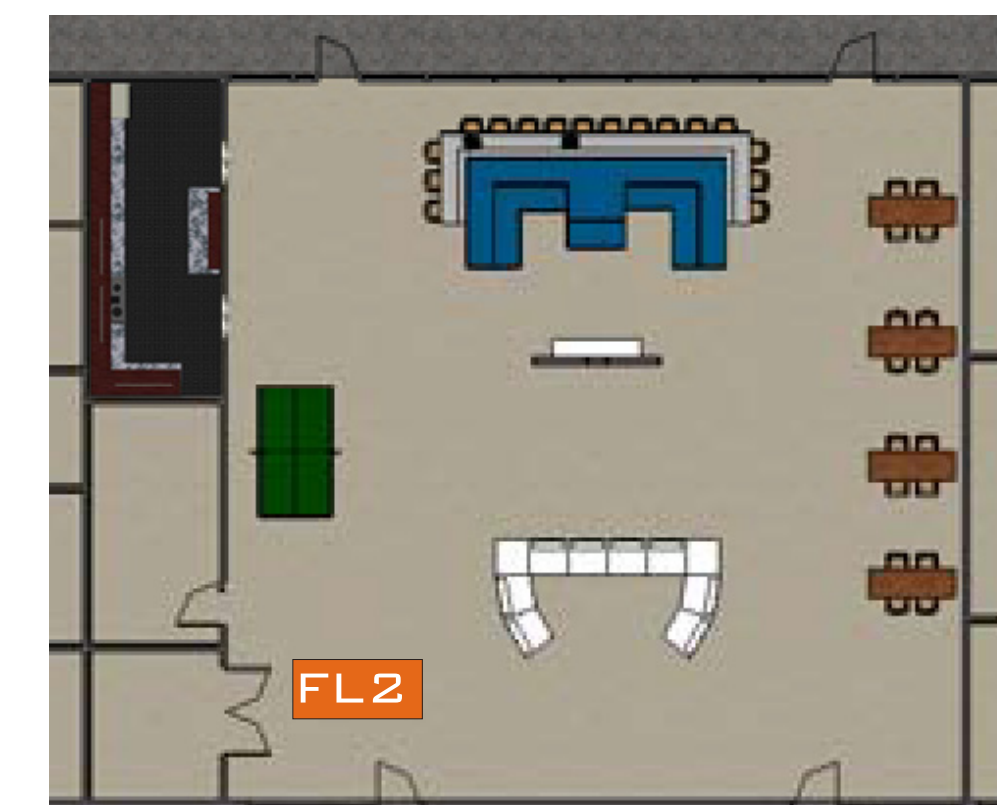

MOLLIE SMITH.  
CHANTELLE BALSER.  
ZECH SMITH.  
MARY JOHANTGES.

### DESIGN STATEMENT

THROUGH THE USE OF INNOVATIVE ARCHITECTURAL ELEMENTS, SPACE PLANNING, AND MATERIAL AND COLOR USAGE, WE MET THE NEEDS AND DESIRES OF OUR CLIENTS, WHICH WAS THE PRIMARY OBJECTIVE IN APPROACHING THIS PROJECT. THE DESIGNS ARE CLEAN, FRESH, AND SIMPLISTIC, ALL CONTRIBUTING TO AN ENGAGING AND INSPIRING ATMOSPHERE THAT WILL STIMULATE A PRODUCTIVE WORK ENVIRONMENT.



# ONTARIO SYSTEMS

## KITCHEN AND FITNESS AREA

MOLLIE SMITH.  
CHANTELLE BALSER.  
ZECH SMITH.  
MARY JOHANTGES.

### DESIGN STATEMENT

THROUGH THE USE OF INNOVATIVE ARCHITECTURAL ELEMENTS, SPACE PLANNING, AND MATERIAL AND COLOR USAGE, WE MET THE NEEDS AND DESIRES OF OUR CLIENTS, WHICH WAS THE PRIMARY OBJECTIVE IN APPROACHING THIS PROJECT. THE DESIGNS ARE CLEAN, FRESH, AND SIMPLISTIC, ALL CONTRIBUTING TO AN ENGAGING AND INSPIRING ATMOSPHERE THAT WILL STIMULATE A PRODUCTIVE WORK ENVIRONMENT.



KITCHEN



FLOOR PLAN

RCP



FITNESS ROOM

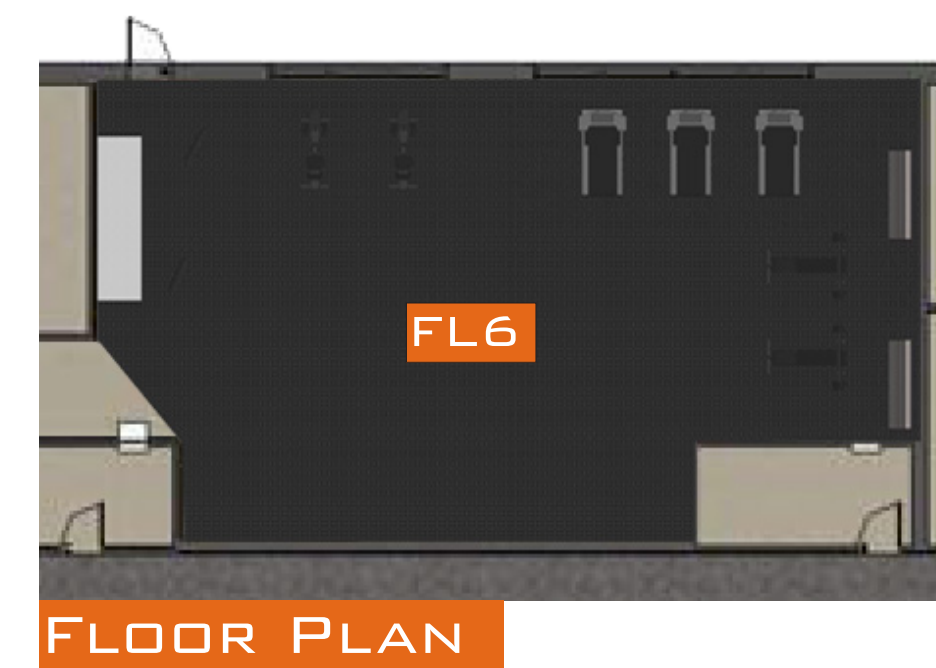

FLOOR PLAN



BEFORE



BEFORE



ELEVATION C

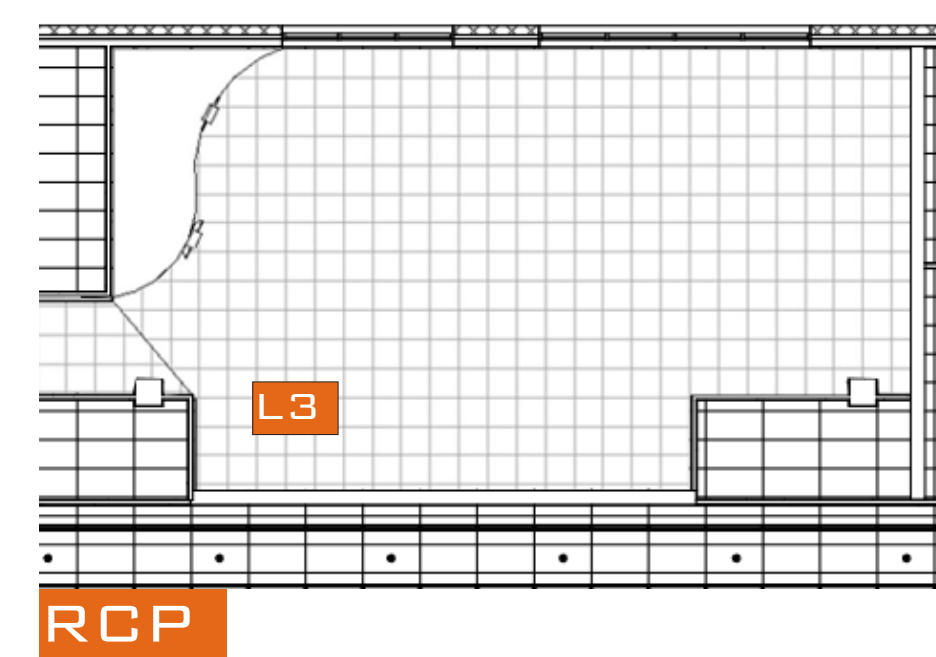

RCP