

# new community spaces

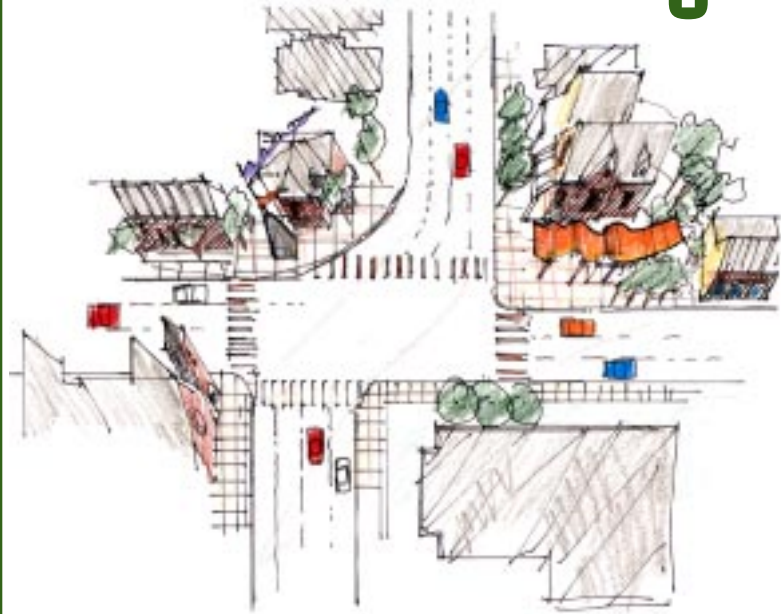

Sixteenth Street was historically a dividing line between two developments and many of the streets do not exactly line up. Many north/south streets like Pennsylvania Street and Delaware Street have had their intersections with 16<sup>th</sup> Street “smoothed,” leaving small pieces of land that for most purposes is not developable. These corner properties represent an opportunity to develop public places and used as bus stops, farmers markets, public art venues, or simple pocket parks.



16th Street and Delaware Street

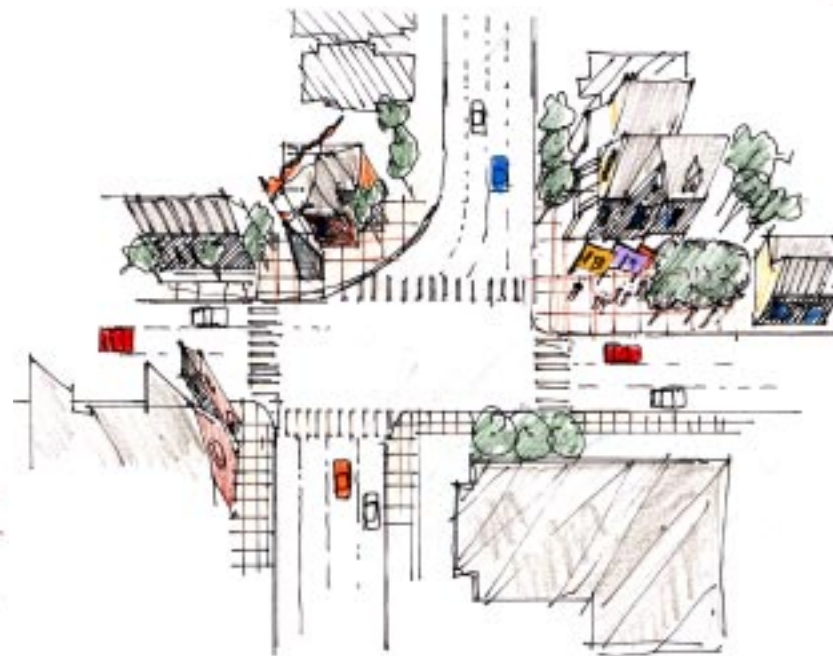

## Gateways & Landmarks

Gateways can provide an identity for an area and need not be simple roadside markers. This sketch illustrates how a sculptured light adds interest during the day but fills the night with excitement. Public infrastructure such as gateway elements, lighting, and signage are opportunities for public art. The engagement of the community in the design and construction of such infrastructure creates a unique identity and also provides the community with ownership in the redevelopment of 16<sup>th</sup> Street.



This rendering shows an arch over 16th Street that denotes a new connection to Martin Luther King Park, an important piece of Indianapolis history. Again, local artists should be involved in the design of any gateway element developed along the corridor.

